

# Media Services / **video and audio production support /**

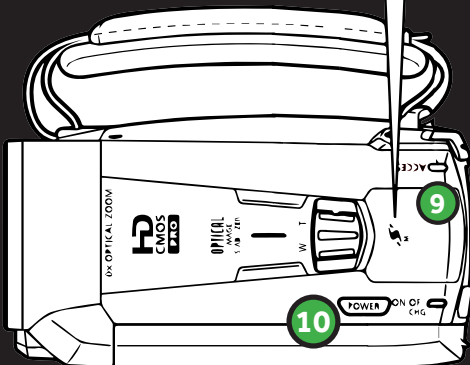

## Canon Legria HFMS2 **Quick Guide**

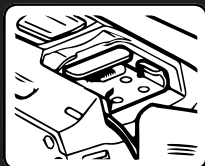
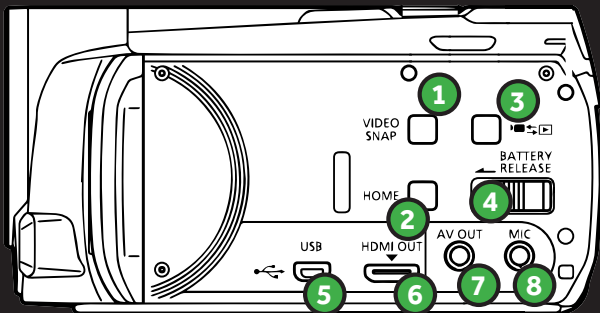

## Canon Legria HFMS2

- |                                 |                                        |
|---------------------------------|----------------------------------------|
| 1. <b>VIDEO SNAPSHOT</b> button | 6. <b>HDMI OUT</b> terminal            |
| 2. <b>HOME</b>                  | 7. <b>AV OUT</b> terminal (headphones) |
| 3. Camera/ play button          | 8. <b>MIC</b> terminal                 |
| 4. <b>BATTERY RELEASE</b>       | 9. <b>Dir. MIC</b> port                |
| 5. USB terminal                 | 10. Power Button                       |

## Using the Canon Legria

- You can rotate the panel 90 degrees downward
- You can rotate the panel 180 degrees toward the lens. The control buttons and menu items that appear on the touch screen change dynamically depending on the operating mode and the task you are performing.
- Press firmly on an element displayed on the touch screen

## How to turn on & record using the camcorder:

- Open LCD Panel and adjust angle
- Press power button to turn on
- Set the camera mode and recording standard
- Press **START/STOP** button to begin recording

## The camcorder can also use:

- Directional microphone - slots on the top as seen in diagram
- Lapel microphone
- Headphones

Time chart

An 32GB SD card will record:

File Format	Time
-------------	------

MP4	378 minutes
AVCHD	600 minutes

Battery life

Recording	approx. 130 minutes
-----------	---------------------

### How to change the camera Mode & Record Settings

- With the LCD screen open press the **HOME** button on the camera
- Press Camera Mode on the LCD screen
- Chose from the three options – **AUTO, MANUAL & CINEMA** – then press **OK**
- To drag, while applying pressure swipe your finger up and down or left and right across the screen. Used to scroll menus, to browse through index screen pages or to adjust slider controls like the volume

### How to use Playback:

- With the LCD screen open press the **HOME** button on the camera
- Press **RECORDING STANDARD**
- Press AVCHD or MP4 and then press **OK**
- With LCD screen open press to switch between camera recording mode and playback mode.
- You can press when camcorder is off to turn it on directly in playback mode.

[www.manchester.ac.uk/mediaservices](http://www.manchester.ac.uk/mediaservices)

0161 275 2523 / humanities bridgeford street building